



CALL FOR FREE QUOTE!

Regain your license in New Jersey

with a state certified ignition interlock

HOW CAN I GET MY LICENSE BACK?

If you are reading this brochure, it is likely that you or a loved one has been pulled over for an alcohol related driving offense. Getting an ignition interlock device (IID) installed in your vehicle may be an important step in regaining your license in New Jersey. This brochure will take you through the necessary steps and explain the requirements based on your offense. This brochure will assist you in getting back on the road quickly and legally.*

*State laws can change at any time. The information in this brochure is a guideline. For the most up to date information, visit www.state.nj.us/mvc/violations/dul_ignition.htm

WHAT IS AN IGNITION INTERLOCK?

An ignition interlock device integrates breath alcohol testing with your vehicle's ignition system. Prior to starting your vehicle, you will need to submit a breath sample into the hand held portion of the device that tests for the presence of alcohol. If your BrAC (Breath Alcohol Concentration) is below New Jersey's ignition interlock limit (0.050), your vehicle will start. If alcohol is detected, your vehicle will not start until a passing sample has been provided.

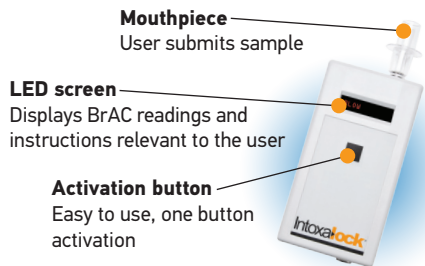

ABOUT INTOXALOCK

Intoxalock has been manufacturing ignition interlocks for over 20 years. We were the first company to use fuel cell technology and continue to be an industry leader in reliability, customer service and technology.



- Over 90,000 customers served annually
- Over 1,800 service centers nationwide
- 20 years of industry leadership

FIRST OFFENSE

If you were convicted of a first offense DUI in New Jersey, your license will be suspended depending on your Breath Alcohol Concentration (BrAC). If your BrAC was greater than 0.08%, but less than 0.10%, your license will be suspended for three months. If your BrAC was greater than 0.10%, your license will be suspended for seven months to one year. Upon the judge's discretion, you may be required to install an Intoxalock ignition interlock device with a BAC at 0.08% or higher.

To obtain your license you must complete the following:

- Pay \$250-\$500 fine
- Pay \$230 program fee and serve 12-48 hours at Intoxicated Driver Resource Center
- Pay \$100 to drunk driving fund and \$75 to Neighborhood Services fund
- Pay \$100 to Alcohol Education and Rehabilitation Fund
- Pay \$1,000/year State surcharge for three years
- Serve any applicable prison time, up to 30 days
- Complete alcohol screening and evaluation program

If your BAC was greater than 0.15% you will be required to complete the above in addition to installing an ignition interlock device (IID) during license suspension and for six months to one year following restoration.

SECOND OFFENSE

If you were convicted of a second offense DUI in New Jersey within ten years, your license will be suspended for two years. However, you may still regain driving privileges with the installation of an Intoxalock ignition interlock device.

In order to regain your license you must:

- Pay \$500-\$1,000 fine
- Complete 30 days of community service
- Pay \$280 program fee and serve 12-48 hours at Intoxicated Driver Resource Center
- Pay \$100 to drunk driving fund and \$75 to Neighborhood Services fund
- Pay \$100 to Alcohol Education and Rehabilitation Fund

- Pay \$1,000/year State surcharge for three years
- Serve applicable prison time, 48 hours to 90 days
- Complete alcohol screening and evaluation program
- Install an ignition interlock device during license suspension and for one to three years following restoration



WE PROUDLY MAINTAIN A 4 ½
STAR CUSTOMER SATISFACTION
RATING ON TRUSTPILOT.

THIRD OFFENSE

If you were convicted of a third DUI offense within ten years of your second offense period in New Jersey, or have four or more alcohol offenses on record, your license will be suspended for ten years. However, you may still regain driving privileges with the installation of an Intoxalock ignition interlock device.

In order to regain your license you must:

- Pay \$1,000 fine
- Complete up to 90 days of community service
- Pay \$280 program fee and serve 12-48 hours at the Intoxicated Driver Resource Center
- Pay \$100 to drunk driving fund and \$75 to Neighborhood Services Fund
- Pay \$100 to Alcohol Education and Rehabilitation Fund
- Pay \$1,500/year State surcharge for three years
- Serve applicable prison time, up to 180 days
- Complete alcohol screening and evaluation program
- Install an ignition interlock device during license suspension and for one to three years following restoration
- Pay \$75 Neighborhood Services Fund

INTOXICATED DRIVING PROGRAM (IDP)

Any person convicted of an alcohol related traffic offense in New Jersey or while driving in another state, but holding a New Jersey driver's license, must participate in a program at an Intoxicated Driving Resource Center (IDRC) as part of the Intoxicated Driving Program. Failure to comply with satisfactory participation will result in further license suspension and possible jail time.

New Jersey has an IDRC in each county for first and third-time offenders and three regional centers for second-time offenders. In addition to the program fees, other related charges may include a \$100 attendance fee and a \$100 license restoration fee.



CALIBRATIONS

New Jersey requires ignition interlock devices to be calibrated every 60 days depending on your IID requirement. A calibration consists of exchanging your current device for a newly calibrated one, ensuring accurate and consistent testing.

Intoxalock auto-calibrations

Intoxalock offers its customers auto-calibrations in the State of New Jersey. When it is time for calibration, the LED screen will display a message alerting you it is time to exchange devices. Intoxalock will automatically send a new one to your selected service center. You simply need to visit your service center during the allotted calibration period and a technician will quickly exchange the device.

LAST YEAR, INTOXALOCK
HELPED OVER 90,000 DRIVERS
GET BACK ON THE ROAD SAFELY
AND RESPONSIBLY.

CERTIFIED INSTALLATION LOCATIONS

Intoxalock has over 45 authorized service center locations throughout the state. **No other ignition interlock provider has more service centers in New Jersey.**

Visit www.Intoxalock.com/Find-an-Installation-Location and enter your zip code to find the service center locations nearest to you.



INTOXALOCK IS THE FASTEST WAY TO REGAIN YOUR LICENSE

5 REASONS TO CALL INTOXALOCK

- 1 New Jersey's #1 ignition interlock provider
- 2 Over 20 years of ignition interlock leadership
- 3 Largest service center network in New Jersey
- 4 Most reliable technology in the industry
- 5 Second-to-none in customer service*

*Given A+ rating from Better Business Bureau and the only ignition interlock company to receive 4-1/2 stars from Trustpilot (Independent site)

WHAT YOU CAN EXPECT

- A patient and friendly customer service agent
- Specialists in New Jersey State regulations
- Affordable pricing
- Convenient service center locations
- 24/7 customer support

Call! **(888) 283-6148** Hablamos Español

Experts in New Jersey regulations are ready to answer your questions.

To learn more about the New Jersey ignition interlock program scan this QR code or visit www.IntoxalockIID.com/NJ



Intoxalock[®]
Helping people to live and drive responsibly

